

1. LEISURE AND LOBBY AREA  
 2. HOTEL ENTRY LOBBY  
 3. HOTEL BAR/LOBBY  
 4. RESTAURANT  
 5. GUESTROOMS AND BATHS  
 6. SPA  
 7. SPA ROOM  
 8. RESTROOMS  
 9. BACK OF HOUSE  
 10. RESTROOMS

- KEY:
- LOBBY AND LOBBY AREA
  - HOTEL ENTRY LOBBY
  - HOTEL BAR/LOBBY / FUNCTIONALITY
  - RESTAURANT
  - GUESTROOMS AND BATHS
  - SPA
  - SPA ROOM
  - RESTROOMS
  - BACK OF HOUSE
  - RESTROOMS

1. LEISURE AND LOBBY AREA  
 2. HOTEL ENTRY LOBBY  
 3. HOTEL BAR/LOBBY  
 4. RESTAURANT  
 5. GUESTROOMS AND BATHS  
 6. SPA  
 7. SPA ROOM  
 8. RESTROOMS  
 9. BACK OF HOUSE  
 10. RESTROOMS

1. LEISURE AND LOBBY AREA  
 2. HOTEL ENTRY LOBBY  
 3. HOTEL BAR/LOBBY  
 4. RESTAURANT  
 5. GUESTROOMS AND BATHS  
 6. SPA  
 7. SPA ROOM  
 8. RESTROOMS  
 9. BACK OF HOUSE  
 10. RESTROOMS

1. LEISURE AND LOBBY AREA  
 2. HOTEL ENTRY LOBBY  
 3. HOTEL BAR/LOBBY  
 4. RESTAURANT  
 5. GUESTROOMS AND BATHS  
 6. SPA  
 7. SPA ROOM  
 8. RESTROOMS  
 9. BACK OF HOUSE  
 10. RESTROOMS

1. LEISURE AND LOBBY AREA  
 2. HOTEL ENTRY LOBBY  
 3. HOTEL BAR/LOBBY  
 4. RESTAURANT  
 5. GUESTROOMS AND BATHS  
 6. SPA  
 7. SPA ROOM  
 8. RESTROOMS  
 9. BACK OF HOUSE  
 10. RESTROOMS

1. LEISURE AND LOBBY AREA  
 2. HOTEL ENTRY LOBBY  
 3. HOTEL BAR/LOBBY  
 4. RESTAURANT  
 5. GUESTROOMS AND BATHS  
 6. SPA  
 7. SPA ROOM  
 8. RESTROOMS  
 9. BACK OF HOUSE  
 10. RESTROOMS

1. LEISURE AND LOBBY AREA  
 2. HOTEL ENTRY LOBBY  
 3. HOTEL BAR/LOBBY  
 4. RESTAURANT  
 5. GUESTROOMS AND BATHS  
 6. SPA  
 7. SPA ROOM  
 8. RESTROOMS  
 9. BACK OF HOUSE  
 10. RESTROOMS

1. LEISURE AND LOBBY AREA  
 2. HOTEL ENTRY LOBBY  
 3. HOTEL BAR/LOBBY  
 4. RESTAURANT  
 5. GUESTROOMS AND BATHS  
 6. SPA  
 7. SPA ROOM  
 8. RESTROOMS  
 9. BACK OF HOUSE  
 10. RESTROOMS

1. LEISURE AND LOBBY AREA  
 2. HOTEL ENTRY LOBBY  
 3. HOTEL BAR/LOBBY  
 4. RESTAURANT  
 5. GUESTROOMS AND BATHS  
 6. SPA  
 7. SPA ROOM  
 8. RESTROOMS  
 9. BACK OF HOUSE  
 10. RESTROOMS

1. LEISURE AND LOBBY AREA  
 2. HOTEL ENTRY LOBBY  
 3. HOTEL BAR/LOBBY  
 4. RESTAURANT  
 5. GUESTROOMS AND BATHS  
 6. SPA  
 7. SPA ROOM  
 8. RESTROOMS  
 9. BACK OF HOUSE  
 10. RESTROOMS

1. LEISURE AND LOBBY AREA  
 2. HOTEL ENTRY LOBBY  
 3. HOTEL BAR/LOBBY  
 4. RESTAURANT  
 5. GUESTROOMS AND BATHS  
 6. SPA  
 7. SPA ROOM  
 8. RESTROOMS  
 9. BACK OF HOUSE  
 10. RESTROOMS

1. LEISURE AND LOBBY AREA  
 2. HOTEL ENTRY LOBBY  
 3. HOTEL BAR/LOBBY  
 4. RESTAURANT  
 5. GUESTROOMS AND BATHS  
 6. SPA  
 7. SPA ROOM  
 8. RESTROOMS  
 9. BACK OF HOUSE  
 10. RESTROOMS

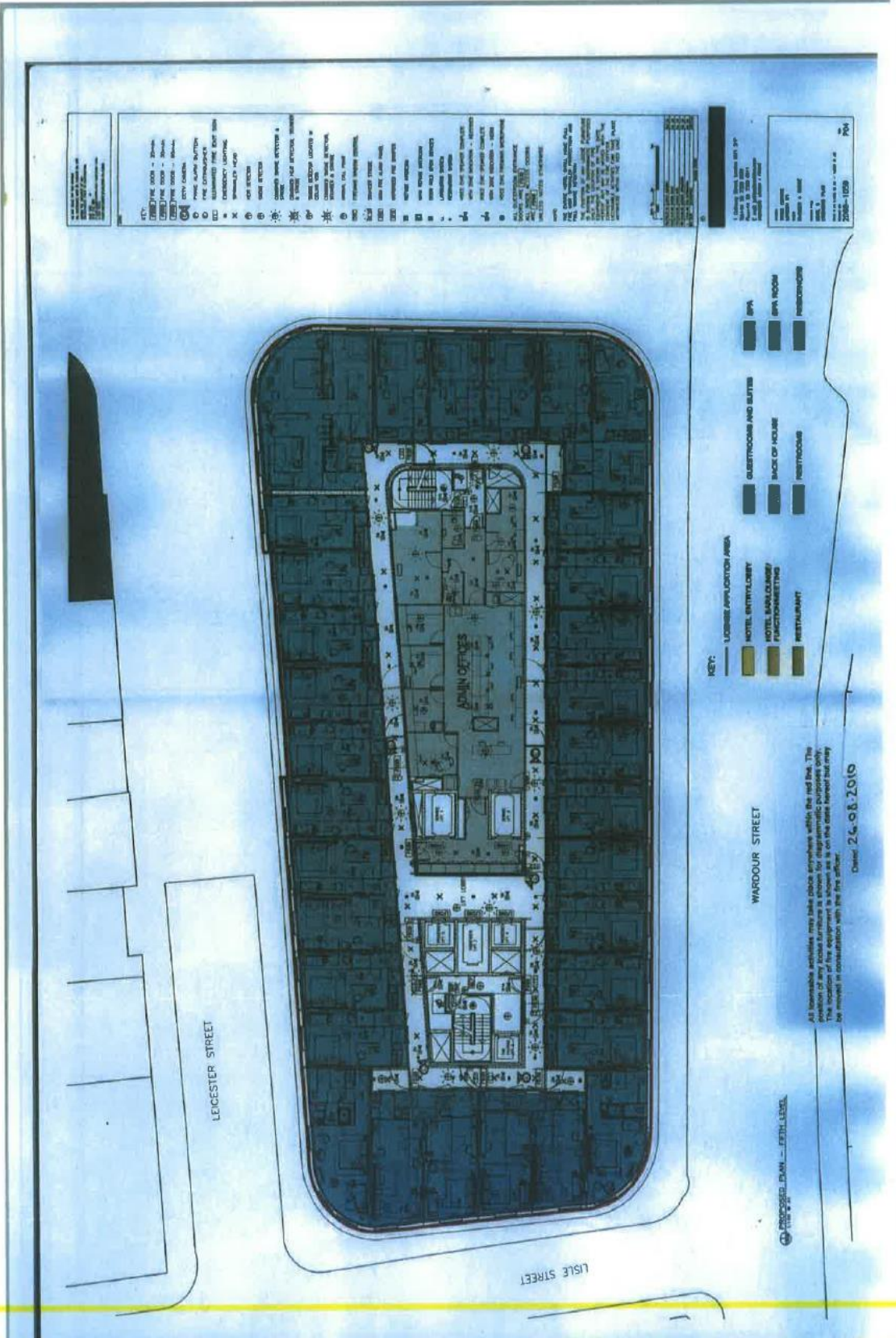

PROPOSED PLAN - FIFTH LEVEL

All foreseeable activities may take place anywhere within the red line. The position of any furniture is shown for design purposes only and is not intended to be used as a basis for any construction. All construction shall be in accordance with the fire officer.

Date: 24.08.2010

**KEY:**

|     |                    |
|-----|--------------------|
| 1   | WALL               |
| 2   | DOOR               |
| 3   | WINDOW             |
| 4   | GLASS CURTAIN WALL |
| 5   | GLASS PARTITION    |
| 6   | GLASS BALUSTRADE   |
| 7   | GLASS RAILING      |
| 8   | GLASS PARTITION    |
| 9   | GLASS PARTITION    |
| 10  | GLASS PARTITION    |
| 11  | GLASS PARTITION    |
| 12  | GLASS PARTITION    |
| 13  | GLASS PARTITION    |
| 14  | GLASS PARTITION    |
| 15  | GLASS PARTITION    |
| 16  | GLASS PARTITION    |
| 17  | GLASS PARTITION    |
| 18  | GLASS PARTITION    |
| 19  | GLASS PARTITION    |
| 20  | GLASS PARTITION    |
| 21  | GLASS PARTITION    |
| 22  | GLASS PARTITION    |
| 23  | GLASS PARTITION    |
| 24  | GLASS PARTITION    |
| 25  | GLASS PARTITION    |
| 26  | GLASS PARTITION    |
| 27  | GLASS PARTITION    |
| 28  | GLASS PARTITION    |
| 29  | GLASS PARTITION    |
| 30  | GLASS PARTITION    |
| 31  | GLASS PARTITION    |
| 32  | GLASS PARTITION    |
| 33  | GLASS PARTITION    |
| 34  | GLASS PARTITION    |
| 35  | GLASS PARTITION    |
| 36  | GLASS PARTITION    |
| 37  | GLASS PARTITION    |
| 38  | GLASS PARTITION    |
| 39  | GLASS PARTITION    |
| 40  | GLASS PARTITION    |
| 41  | GLASS PARTITION    |
| 42  | GLASS PARTITION    |
| 43  | GLASS PARTITION    |
| 44  | GLASS PARTITION    |
| 45  | GLASS PARTITION    |
| 46  | GLASS PARTITION    |
| 47  | GLASS PARTITION    |
| 48  | GLASS PARTITION    |
| 49  | GLASS PARTITION    |
| 50  | GLASS PARTITION    |
| 51  | GLASS PARTITION    |
| 52  | GLASS PARTITION    |
| 53  | GLASS PARTITION    |
| 54  | GLASS PARTITION    |
| 55  | GLASS PARTITION    |
| 56  | GLASS PARTITION    |
| 57  | GLASS PARTITION    |
| 58  | GLASS PARTITION    |
| 59  | GLASS PARTITION    |
| 60  | GLASS PARTITION    |
| 61  | GLASS PARTITION    |
| 62  | GLASS PARTITION    |
| 63  | GLASS PARTITION    |
| 64  | GLASS PARTITION    |
| 65  | GLASS PARTITION    |
| 66  | GLASS PARTITION    |
| 67  | GLASS PARTITION    |
| 68  | GLASS PARTITION    |
| 69  | GLASS PARTITION    |
| 70  | GLASS PARTITION    |
| 71  | GLASS PARTITION    |
| 72  | GLASS PARTITION    |
| 73  | GLASS PARTITION    |
| 74  | GLASS PARTITION    |
| 75  | GLASS PARTITION    |
| 76  | GLASS PARTITION    |
| 77  | GLASS PARTITION    |
| 78  | GLASS PARTITION    |
| 79  | GLASS PARTITION    |
| 80  | GLASS PARTITION    |
| 81  | GLASS PARTITION    |
| 82  | GLASS PARTITION    |
| 83  | GLASS PARTITION    |
| 84  | GLASS PARTITION    |
| 85  | GLASS PARTITION    |
| 86  | GLASS PARTITION    |
| 87  | GLASS PARTITION    |
| 88  | GLASS PARTITION    |
| 89  | GLASS PARTITION    |
| 90  | GLASS PARTITION    |
| 91  | GLASS PARTITION    |
| 92  | GLASS PARTITION    |
| 93  | GLASS PARTITION    |
| 94  | GLASS PARTITION    |
| 95  | GLASS PARTITION    |
| 96  | GLASS PARTITION    |
| 97  | GLASS PARTITION    |
| 98  | GLASS PARTITION    |
| 99  | GLASS PARTITION    |
| 100 | GLASS PARTITION    |

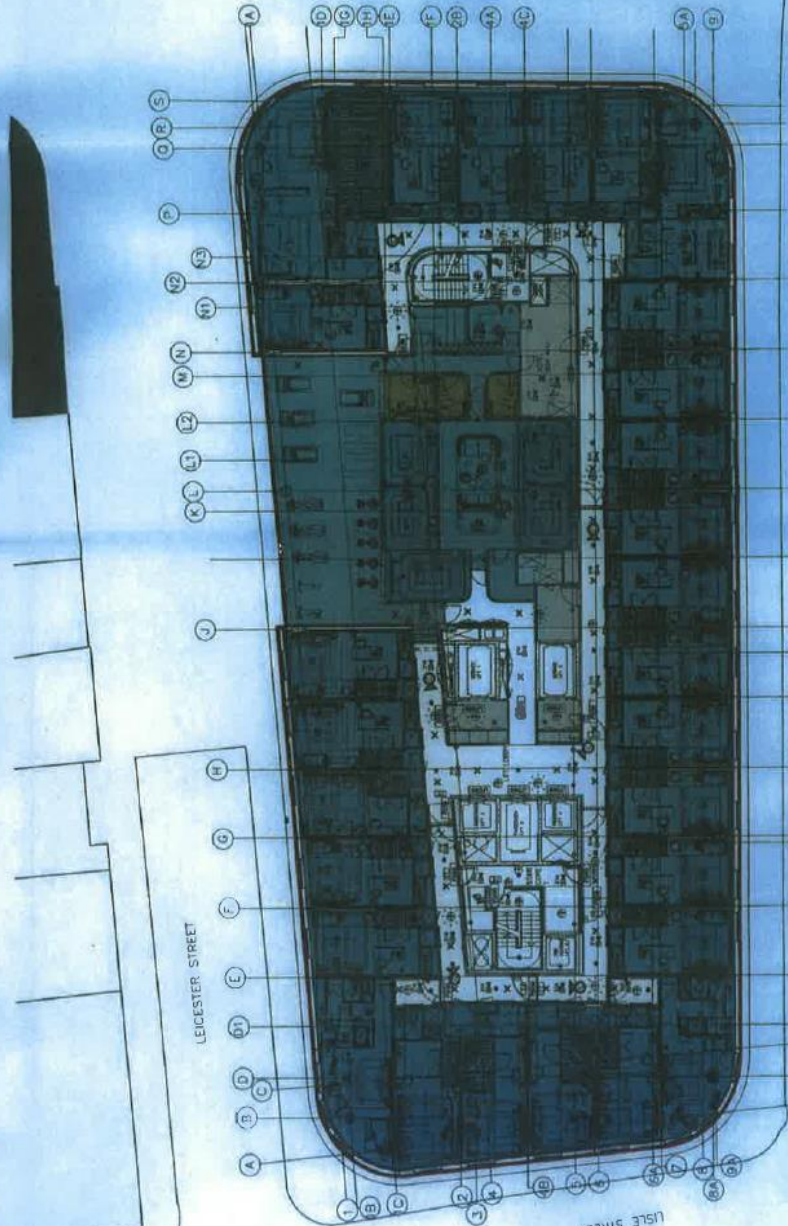

- KEY:**
- LOBBY/RECEPTION AREA
  - HOTEL ENTRANCE
  - HOTEL BACK OFFICE
  - FUNCTION/MEETING
  - RESTAURANT
  - QUARTERS AND SUITES
  - BACK OF HOUSE
  - RESTROOM
  - SPA
  - SPA ROOM
  - RESIDENCE

WARDOUR STREET

LEICESTER STREET

100-101

102-103

104-105

106-107

108-109

110-111

112-113

114-115

116-117

118-119

120-121

122-123

124-125

126-127

128-129

130-131

132-133

134-135

136-137

138-139

140-141

142-143

144-145

146-147

148-149

150-151

152-153

154-155

156-157

158-159

160-161

162-163

164-165

166-167

168-169

170-171

172-173

174-175

176-177

178-179

180-181

182-183

184-185

186-187

188-189

190-191

192-193

194-195

196-197

198-199

200-201

PROPOSED PLAN - HOTEL LEVEL

All dimensions are in millimetres unless otherwise stated. The location of this information is shown as to be in the design but may be received in consultation with the architect.

Drawn: Z. S. 2000

100-101

102-103

104-105

106-107

108-109

110-111

112-113

114-115

116-117

118-119

120-121

122-123

124-125

126-127

128-129

130-131

132-133

134-135

136-137

138-139

140-141

142-143

144-145

146-147

148-149

150-151

152-153

154-155

156-157

158-159

160-161

162-163

164-165

166-167

168-169

170-171

172-173

174-175

176-177

178-179

180-181

182-183

184-185

186-187

188-189

190-191

192-193

194-195

196-197

198-199

200-201

ALL DIMENSIONS IN METERS  
 UNLESS OTHERWISE SPECIFIED  
 DRAWN BY: [Name]  
 CHECKED BY: [Name]  
 DATE: [Date]

- A1: ROOM NO. - 2000  
 A2: ROOM NO. - 2000  
 A3: ROOM NO. - 2000  
 A4: ROOM NO. - 2000  
 A5: ROOM NO. - 2000  
 A6: ROOM NO. - 2000  
 A7: ROOM NO. - 2000  
 A8: ROOM NO. - 2000  
 A9: ROOM NO. - 2000  
 A10: ROOM NO. - 2000  
 A11: ROOM NO. - 2000  
 A12: ROOM NO. - 2000  
 A13: ROOM NO. - 2000  
 A14: ROOM NO. - 2000  
 A15: ROOM NO. - 2000  
 A16: ROOM NO. - 2000  
 A17: ROOM NO. - 2000  
 A18: ROOM NO. - 2000  
 A19: ROOM NO. - 2000  
 A20: ROOM NO. - 2000  
 A21: ROOM NO. - 2000  
 A22: ROOM NO. - 2000  
 A23: ROOM NO. - 2000  
 A24: ROOM NO. - 2000  
 A25: ROOM NO. - 2000  
 A26: ROOM NO. - 2000  
 A27: ROOM NO. - 2000  
 A28: ROOM NO. - 2000  
 A29: ROOM NO. - 2000  
 A30: ROOM NO. - 2000  
 A31: ROOM NO. - 2000  
 A32: ROOM NO. - 2000  
 A33: ROOM NO. - 2000  
 A34: ROOM NO. - 2000  
 A35: ROOM NO. - 2000  
 A36: ROOM NO. - 2000  
 A37: ROOM NO. - 2000  
 A38: ROOM NO. - 2000  
 A39: ROOM NO. - 2000  
 A40: ROOM NO. - 2000  
 A41: ROOM NO. - 2000  
 A42: ROOM NO. - 2000  
 A43: ROOM NO. - 2000  
 A44: ROOM NO. - 2000  
 A45: ROOM NO. - 2000  
 A46: ROOM NO. - 2000  
 A47: ROOM NO. - 2000  
 A48: ROOM NO. - 2000  
 A49: ROOM NO. - 2000  
 A50: ROOM NO. - 2000  
 A51: ROOM NO. - 2000  
 A52: ROOM NO. - 2000  
 A53: ROOM NO. - 2000  
 A54: ROOM NO. - 2000  
 A55: ROOM NO. - 2000  
 A56: ROOM NO. - 2000  
 A57: ROOM NO. - 2000  
 A58: ROOM NO. - 2000  
 A59: ROOM NO. - 2000  
 A60: ROOM NO. - 2000  
 A61: ROOM NO. - 2000  
 A62: ROOM NO. - 2000  
 A63: ROOM NO. - 2000  
 A64: ROOM NO. - 2000  
 A65: ROOM NO. - 2000  
 A66: ROOM NO. - 2000  
 A67: ROOM NO. - 2000  
 A68: ROOM NO. - 2000  
 A69: ROOM NO. - 2000  
 A70: ROOM NO. - 2000  
 A71: ROOM NO. - 2000  
 A72: ROOM NO. - 2000  
 A73: ROOM NO. - 2000  
 A74: ROOM NO. - 2000  
 A75: ROOM NO. - 2000  
 A76: ROOM NO. - 2000  
 A77: ROOM NO. - 2000  
 A78: ROOM NO. - 2000  
 A79: ROOM NO. - 2000  
 A80: ROOM NO. - 2000  
 A81: ROOM NO. - 2000  
 A82: ROOM NO. - 2000  
 A83: ROOM NO. - 2000  
 A84: ROOM NO. - 2000  
 A85: ROOM NO. - 2000  
 A86: ROOM NO. - 2000  
 A87: ROOM NO. - 2000  
 A88: ROOM NO. - 2000  
 A89: ROOM NO. - 2000  
 A90: ROOM NO. - 2000  
 A91: ROOM NO. - 2000  
 A92: ROOM NO. - 2000  
 A93: ROOM NO. - 2000  
 A94: ROOM NO. - 2000  
 A95: ROOM NO. - 2000  
 A96: ROOM NO. - 2000  
 A97: ROOM NO. - 2000  
 A98: ROOM NO. - 2000  
 A99: ROOM NO. - 2000  
 A100: ROOM NO. - 2000

DRAWING NO. [Number]  
 SHEET NO. [Number]  
 DATE: [Date]  
 SCALE: [Scale]  
 PROJECT: [Project Name]

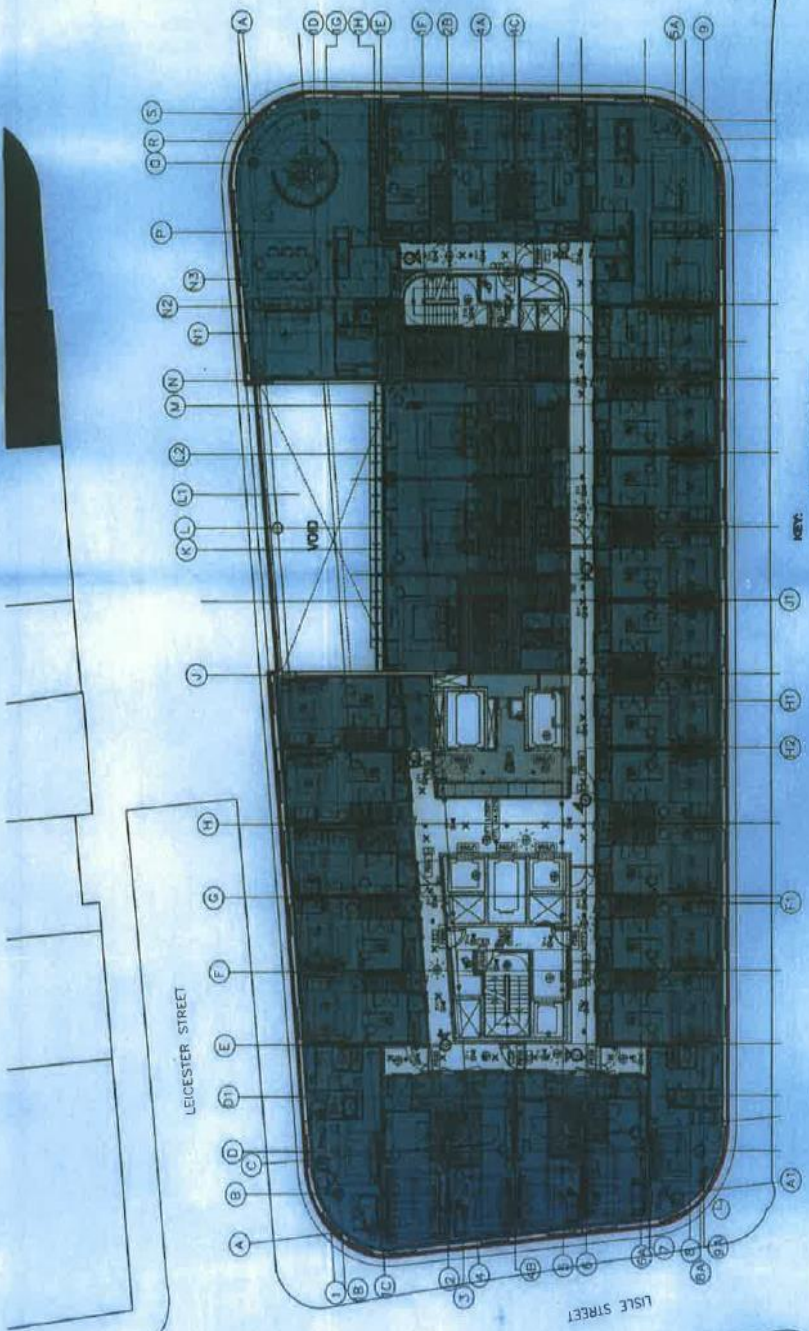

- KEY:**  
 - LOBBY APPLICATION AREA  
 - HOTEL ENTRY/LOBBY  
 - HOTEL BACK OF HOUSE  
 - HOTEL RESTAURANT  
 - GUESTROOMS AND SUITES  
 - BACK OF HOUSE  
 - RESTROOMS  
 - SPA  
 - SPA ROOM  
 - RESTROOMS

LEICESTER STREET  
 WARDOUR STREET  
 LISLE STREET

PROPOSED PLAN - SECOND LEVEL  
 Date: 26.03.2010

ALL SPECIFIABLE ACTIVITIES MAY TAKE PLACE ANYWHERE WITHIN THE RED LINE. THE LOCATION OF ANY BUILT FORMS IS SHOWN FOR DIAGNOSTIC PURPOSES ONLY. THE LOCATION OF ANY BUILT FORMS ON THE GROUND FLOOR MAY BE MODIFIED IN CONSULTATION WITH THE OFFICE.



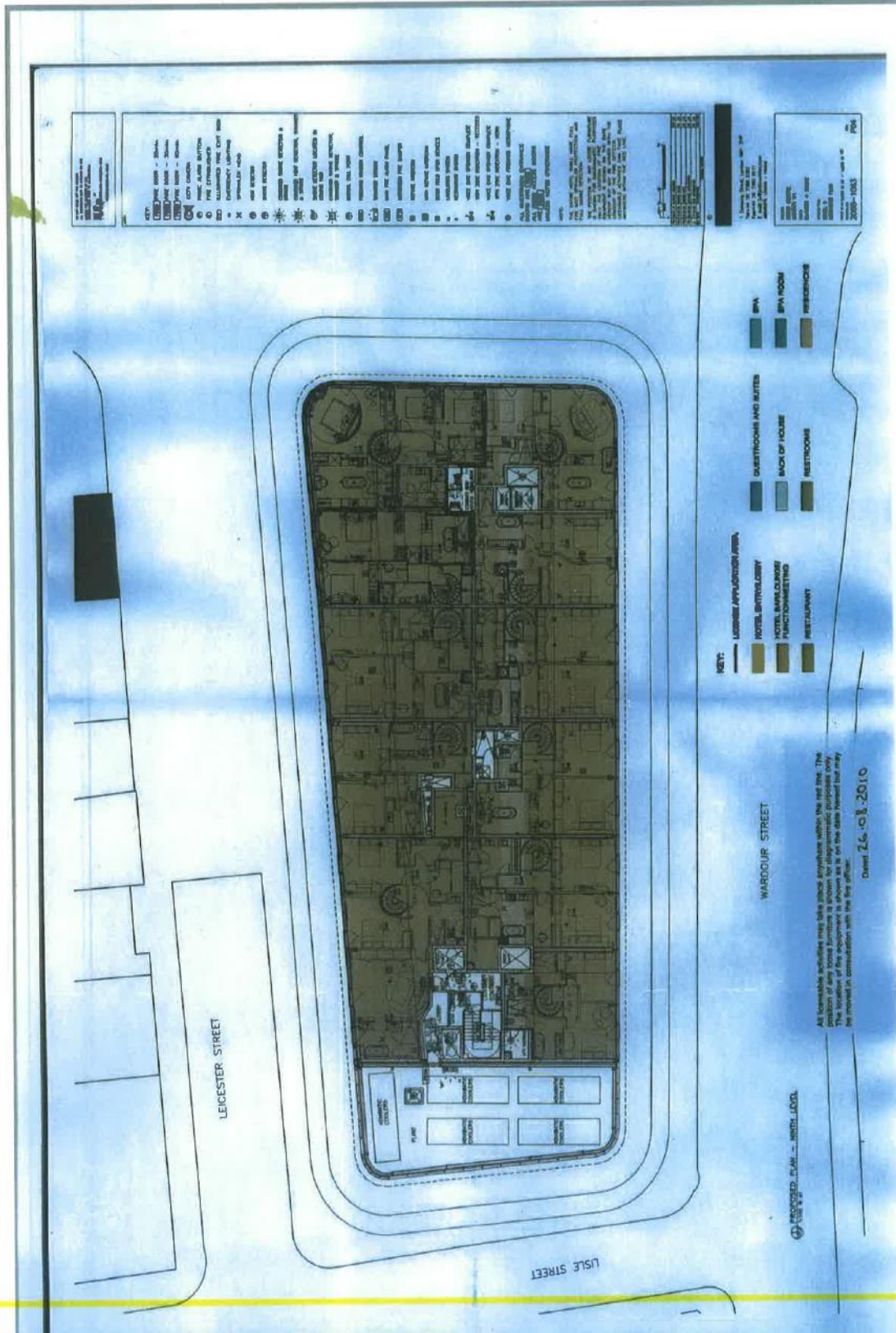

- KEY:**
- ① FIRE ESCAPE
  - ② FIRE ESCAPE
  - ③ FIRE ESCAPE
  - ④ FIRE ESCAPE
  - ⑤ FIRE ESCAPE
  - ⑥ FIRE ESCAPE
  - ⑦ FIRE ESCAPE
  - ⑧ FIRE ESCAPE
  - ⑨ FIRE ESCAPE
  - ⑩ FIRE ESCAPE
  - ⑪ FIRE ESCAPE
  - ⑫ FIRE ESCAPE
  - ⑬ FIRE ESCAPE
  - ⑭ FIRE ESCAPE
  - ⑮ FIRE ESCAPE
  - ⑯ FIRE ESCAPE
  - ⑰ FIRE ESCAPE
  - ⑱ FIRE ESCAPE
  - ⑲ FIRE ESCAPE
  - ⑳ FIRE ESCAPE
  - ㉑ FIRE ESCAPE
  - ㉒ FIRE ESCAPE
  - ㉓ FIRE ESCAPE
  - ㉔ FIRE ESCAPE
  - ㉕ FIRE ESCAPE
  - ㉖ FIRE ESCAPE
  - ㉗ FIRE ESCAPE
  - ㉘ FIRE ESCAPE
  - ㉙ FIRE ESCAPE
  - ㉚ FIRE ESCAPE
  - ㉛ FIRE ESCAPE
  - ㉜ FIRE ESCAPE
  - ㉝ FIRE ESCAPE
  - ㉞ FIRE ESCAPE
  - ㉟ FIRE ESCAPE
  - Ⓜ FIRE ESCAPE
  - Ⓝ FIRE ESCAPE
  - Ⓞ FIRE ESCAPE
  - Ⓟ FIRE ESCAPE
  - Ⓠ FIRE ESCAPE
  - Ⓡ FIRE ESCAPE
  - Ⓢ FIRE ESCAPE
  - Ⓣ FIRE ESCAPE
  - Ⓤ FIRE ESCAPE
  - Ⓥ FIRE ESCAPE
  - Ⓦ FIRE ESCAPE
  - Ⓧ FIRE ESCAPE
  - Ⓨ FIRE ESCAPE
  - Ⓩ FIRE ESCAPE
  - ⓐ FIRE ESCAPE
  - ⓑ FIRE ESCAPE
  - ⓒ FIRE ESCAPE
  - ⓓ FIRE ESCAPE
  - ⓔ FIRE ESCAPE
  - ⓕ FIRE ESCAPE
  - ⓖ FIRE ESCAPE
  - ⓗ FIRE ESCAPE
  - ⓘ FIRE ESCAPE
  - ⓙ FIRE ESCAPE
  - ⓚ FIRE ESCAPE
  - ⓛ FIRE ESCAPE
  - ⓜ FIRE ESCAPE
  - ⓝ FIRE ESCAPE
  - ⓞ FIRE ESCAPE
  - ⓟ FIRE ESCAPE
  - ⓠ FIRE ESCAPE
  - ⓡ FIRE ESCAPE
  - ⓢ FIRE ESCAPE
  - ⓣ FIRE ESCAPE
  - ⓤ FIRE ESCAPE
  - ⓥ FIRE ESCAPE
  - ⓦ FIRE ESCAPE
  - ⓧ FIRE ESCAPE
  - ⓨ FIRE ESCAPE
  - ⓩ FIRE ESCAPE
  - ⓪ FIRE ESCAPE
  - ⓫ FIRE ESCAPE
  - ⓬ FIRE ESCAPE
  - ⓭ FIRE ESCAPE
  - ⓮ FIRE ESCAPE
  - ⓯ FIRE ESCAPE
  - ⓰ FIRE ESCAPE
  - ⓱ FIRE ESCAPE
  - ⓲ FIRE ESCAPE
  - ⓳ FIRE ESCAPE
  - ⓴ FIRE ESCAPE
  - ⓵ FIRE ESCAPE
  - ⓶ FIRE ESCAPE
  - ⓷ FIRE ESCAPE
  - ⓸ FIRE ESCAPE
  - ⓹ FIRE ESCAPE
  - ⓺ FIRE ESCAPE
  - ⓻ FIRE ESCAPE
  - ⓼ FIRE ESCAPE
  - ⓽ FIRE ESCAPE
  - ⓾ FIRE ESCAPE
  - ⓿ FIRE ESCAPE

- KEY:**
- LUBRICATION APPLICATION AREA
  - HOTEL BATHROOM
  - HOTEL BATHROOM/ FUNCTION/RESTROOM
  - RESTAURANT
  - GUESTROOMS AND SUITES
  - BACK OF HOUSE
  - RESTROOMS
  - SPA
  - SPA ROOM
  - RECEPTION

All foreseeable activities may take place anywhere within the red line. The position of any loose furniture is shown for diagrammatic purposes only. The location of the equipment is shown as is on the date issued but may be provided in consultation with the fire officer.

Date: 26.03.2010

PROPOSED PLAN - 1ST FLOOR



**City of Westminster**  
64 Victoria Street, London, SW1E 6QP

Schedule 12  
Part B

WARD: St James's  
UPRN: 010033615444

Premises licence  
summary

Regulation 33, 34

Premises licence number:

17/11814/LIPDPS

**Part 1 – Premises details**

**Postal address of premises:**

W Hotel  
W London Leicester Square  
10 Wardour Street  
London  
W1D 6QF

**Telephone Number:** Not Supplied

**Where the licence is time limited, the dates:**

Not applicable

**Licensable activities authorised by the licence:**

Performance of Dance  
Exhibition of a Film  
Performance of Live Music  
Playing of Recorded Music  
Anything of a similar description to Live Music, Recorded Music or Performance of Dance  
Performance of a Play  
Late Night Refreshment  
Sale by Retail of Alcohol

**The times the licence authorises the carrying out of licensable activities:**

**Performance of Dance**

Monday to Sunday: 00:00 to 00:00 (See restricted conditions 31, 32 & 35)

**Exhibition of a Film**

Monday to Sunday: 00:00 to 00:00 (See restricted conditions 31, 32 & 35)

**Performance of Live Music**

Monday to Sunday: 00:00 to 00:00 (See restricted conditions 31, 32 & 35)

**Playing of Recorded Music**

Monday to Sunday: 00:00 to 00:00 (See restricted conditions 31, 32 & 35)

**Anything of a similar description to Live Music, Recorded Music or Performance of Dance**

Monday to Sunday: 00:00 to 00:00 (See restricted conditions 31, 32 & 35)

**Performance of a Play**

Monday to Sunday: 00:00 to 00:00 (See restricted conditions 31, 32 & 35)

**Late Night Refreshment**

Monday to Sunday: 23:00 to 05:00

**Sale by Retail of Alcohol**

Monday to Sunday: 00:00 to 00:00 (See restricted conditions 26 & 33)

*For times authorised for New Year see conditions at Annex 3*

**The opening hours of the premises:**

Monday to Sunday: 00:00 to 00:00

**Where the licence authorises supplies of alcohol, whether these are on and/or off supplies:**

Alcohol is supplied for consumption both on and off the Premises.

**Name and (registered) address of holder of premises licence:**

W Leicester Square Limited  
C/o The Park Lane Hotel  
Piccadilly  
London  
W1J 7BX

**Registered number of holder, for example company number, charity number (where applicable)**

06876751

**Name of designated premises supervisor where the premises licence authorises for the supply of alcohol:**

**Name:** Dario Mazzoli

**State whether access to the premises by children is restricted or prohibited:**

Restricted

**Date:** 3 November 2017

**This licence has been authorised by Mary Pring on behalf of the Director - Public Protection and Licensing.**

PROTECTIVE MARKING

**METROPOLITAN  
POLICE****TOTAL POLICING**

Form 693

**Form for Applying for a Summary Licence Review**  
**Application for the review of a premises licence under section 53A of the Licensing Act 2003**  
 (premises associated with serious crime, serious disorder or both)

**PLEASE READ THE FOLLOWING INSTRUCTIONS FIRST**

Before completing this form please read the guidance notes at the end of the form. If you are completing the form by hand please write legibly in block capitals. In all cases ensure that your answers are inside the boxes and written in black ink.

Use additional sheets if necessary.

**Insert name and address of relevant licensing authority and its reference number:**

Name: City of Westminster

Address: Westminster City Hall, 64 Victoria Street

Post town: London

Post code: SW1E 6QP

Ref. No.: 17/11814/LIPDPS

**I Pc Steve Muldoon**

on behalf of the chief officer of police for the Metropolitan Police area apply for the review of a premises licence under section 53A of the Licensing Act 2003.

**1. Premises details**

Postal address of premises or club premises, or if none, ordnance survey map reference or description:

W Hotel, Leicester Square, 10 Wardour Street

Post town: London

Post code:  
(if known) W1D 6QF**2. Premises licence details**

Name of premises licence holder or club holding club premises certificate (if known):

W Leicester Sq Limited

Number of premises licence or club premises certificate (if known):

17/11814/LIPDPS



## PROTECTIVE MARKING

### 3. Certificate under section 53A(1)(b) of the Licensing Act 2003 (Please read guidance note 1)

I confirm that a certificate has been given by a senior member of the police force for the police area above that in his opinion the above premises are associated with serious crime or serious disorder or both, and the certificate accompanies this application.

Please tick the box to confirm:



### 4. Details of association of the above premises with serious crime, serious disorder or both (Please read guidance note 2)

On Sunday 10th July 2022 at approximately 22:30 Police were called to a large fight within the bar area of the W Hotel 10 Wardour St, W1D.

Officers responded to a call to police that suggested 30/40 people were fighting in the bar. 2 officers arrived and were immediately faced with large scale disorder witnessing including witnessing a male punching others with a belt wrapped round his fist. Officers immediately became under attack with glass bottles being thrown at them in the bar, officers deployed Pava spray and used baton strikes in an attempt to contain the violence, however, this continued. Officers continued to have bottles and glass thrown at them and had to leave the venue to retreat to safety. Further officers arrived and they were then able to get back up and then subsequently re-enter and contain the situation.

Officers identified a manager and members of security, and began to establish the circumstances. Officers on scene spoke with witnesses and were advised that there had been drug use in the toilets of the bar area whilst other door supervisors advised officers that they had at the start of the night identified to hotel management, that they did not feel this event should run, as it appeared from customers arriving, the door supervisors were concerned that the customers would behave inappropriately due to the fact many were wearing ankle tags. The door supervisors indicated to officers that they had mentioned to management that previous events like this saw clear drug use inside the venue.

Officers on scene assessed injuries and identified 5 door supervisors with injuries that all required hospital treatment, this ranged from a chipped tooth, lacerations to the head, large bump on the head to minor cuts. 2 police officers that attended were also injured having been struck with glass bottles.

Officers made 3 arrests at the time, however, many more are likely to be made in the coming weeks.

Officers from the Police licensing team attended a planned meeting with the DPS and Security manager on Tuesday 12th July 2022. Officers established this was an event that had been conducted in the hotel by an external promotor and had initially been booked for 200 ticket holders. The DPS indicated the event was run by a promotor event under the name of Chalet.

Police request that the licensing sub-committee consider suspension of the premises license pending a full hearing. The interim steps are deemed both necessary and proportionate to reduce the risk of further serious violence or disorder pending a full hearing where the Metropolitan Police will seek revocation of the premises licence.

PROTECTIVE MARKING

| Signature of applicant                                  |   |              |                             |
|---|---|--------------|-----------------------------|
| Signature:  |  | Date:        | 19/07/2022                  |
| Capacity:   | Police Constable  |              |                             |
| Contact details for matters concerning this application |   |              |                             |
| Surname:  | Muldoon   | First Names: | Steve                       |
| Address:  | Westminster City Hall, 4th Floor, 64 Victoria Street                              |              |                             |
| Post town:  | London  | Post code:   | SW1E 6QP                    |
| Tel. No.:   | 07442 419872  | Email:       | Steve.muldoon@met.police.uk |

Notes for guidance

1. A certificate of the kind mentioned in the form must accompany the application in order for it to be valid under the terms of the Licensing Act 2003. The certificate must explicitly state the senior officer's opinion that the premises in question are associated with serious crime, serious disorder or both.  
Serious crime is defined by reference to section 81 of the Regulation of Investigatory Powers Act 2000. In summary, it means:
  - conduct that amounts to one or more criminal offences for which a person who has attained the age of eighteen and has no previous convictions could reasonably be expected to be sentenced to imprisonment for a term of three years or more; or
  - conduct that amounts to one or more criminal offences and involves the use of violence, results in substantial financial gain or is conduct by a large number of persons in pursuit of a common purpose.  
Serious disorder is not defined in legislation, and so bears its ordinary English meaning.
2. Briefly describe the circumstances giving rise to the opinion that the above premises are associated with serious crime, serious disorder, or both.

Retention Period: 7 years  
MP 146/12



**METROPOLITAN  
POLICE**

**TOTAL POLICING**

## Certificate under Section 53A(1)(b) of the Licensing Act 2003

**Metropolitan Police Service | New Scotland | Yard 8-10 Broadway | London | SW1H 0BG**

**I hereby certify that in my opinion the premises described below are associated with:  
Serious Crime & Serious Disorder**

**Premises** (Include business name and address and any other relevant identifying details):

**Postal address of premises or club premises, or if none, ordnance survey map reference or description:**

W Hotel, Leicester Square, 10 Wardour Street

|                   |        |                                  |         |
|-------------------|--------|----------------------------------|---------|
| <b>Post town:</b> | London | <b>Post code:<br/>(if known)</b> | W1D 6QF |
|-------------------|--------|----------------------------------|---------|

**Premises licence number (if known):**

17/11814/LIPDPS

**Name of premises supervisor (if known):**

Dario Mazzoli

**I am a Superintendent\* in the Metropolitan Police Service.**

\*Insert rank of officer giving the certificate, which must be superintendent or above.

**I am giving this certificate because I am of the opinion that other procedures under the Licensing Act are inappropriate in this case because:**

(Give a brief description of why other procedures such as a standard review process are thought to be inappropriate, e.g. the degree of seriousness of the crime and/or disorder, the past history of compliance in relation to the premises concerned)

On Sunday 10th July 2022 at approximately 2230hrs officers have responded to a call to the premises and on arrival have been confronted with a large scale fight involving upwards of 30 people. These individuals have been using belts and bottles as weapons and due to the severity of the violence and becoming under sustained attack, the initial officers have had to make a tactical withdrawal and await further resources to deal with the disorder. The number of injuries to a GBH level requiring hospitalization is significant and this is an active investigation with multiple suspects still outstanding.

The reason this incident necessitates a Summary Review under Section 53A(1)(b) of the Licensing Act 2003 are as follows.

- In April of this year a similar, all be it less serious incident, resulting in GBH injuries occurred at the premises. Engagement was undertaken with the premises from the Police Licensing Team to support and advise them as to mitigating a repeat. This included the inherent risks of holding events, including externally promoted events. An action plan was set by the venue. However, it is the view of the Metropolitan Police that these concerns were not taken seriously and an initial assessment would indicate that the action plan set has not been adhered to, even after assurances from the operator.
- The poor management and lack of action leading to the events of the 10<sup>th</sup> July significantly contributed to the incident in question. No risk assessments were undertaken by the venue and when risks were identified by staff on the night, these were ignored by management.

It is clear that the current standard of management with consideration to the Licensing Objectives, falls well below those expected of responsible licensees in Westminster. There is a distinct lack of learning from past history and taking the necessary decisions in real time to provide a safe environment for their customers and the wider public. As such I believe Interim Steps should be imposed onto the premises licence pending review at Licensing Sub Committee.

PROTECTIVE MARKING

| Signature         |   |              |            |
|-------------------|---|--------------|------------|
|                   |  |              |            |
| <b>Signature:</b> | <b>Superintendent Michael Walsh</b>   | <b>Date:</b> | 15.07.2022 |

Retention Period: 7 years  
MP 147/12

RESTRICTED (when complete)

MG11

|   |                        |
|---|------------------------|
| <b>STATEMENT OF WITNESS</b><br><i>(Criminal Procedure Rules, r. 16.2; Criminal Justice Act 1967, s. 9)</i>  |                        |
| URN   | <input type="text"/>   |
| Statement of: Constable Dameen Ali<br>Age if under 18: Over 18<br>Occupation: Police officer  |                        |
| This statement is true to the best of my knowledge and belief and I make it knowing that, if it is tendered in evidence, I shall be liable to prosecution if I have wilfully stated in it, anything which I know to be false, or do not believe to be true. |                        |
| Signature:  | <i>PC D Ali 2826PM</i> |
| Date:   | 11 Jul 2022            |

This is a statement relating to an incident that occurred whilst on duty whereby I was a victim of assault.

The relevant people mentioned throughout this statement are myself, my colleague who I was partnered with, PC GALLI 3461AW, the person who assaulted me is unknown as I was assaulted from behind and at no point saw this person.

On SUNDAY 10TH JULY 2022, I was on duty in full uniform, tasked with cycling patrols in the WEST END OF LONDON. I was paired with my colleague PC GALLI 3461AW, when a call came over my personal radio at approximately 2230HOURS, regarding a fight W HOTEL, WARDOUR STREET W1. PC GALLI 3461AW assigned us to the call, CAD 8070/10JUL22 refers. PC GALLI 3461AW and myself arrived on scene at approximately 2234HOURS. As soon as we arrived, PC GALLI and I entered the lift and have gone up to the first floor as directed by the door staff. When the lift doors open I could see approximately twenty to thirty people fighting and throwing punches at each other. I have then tried to split apart males from fighting and I have grabbed a few males and pushed them away. There was security staff who all seemed injured with cuts and blood from there face. I then remember a topless white male who seemed to be the most aggressor attacking different people. I have released my PAVA spray out of my duty belt and have pointed it at this topless white male. I have told him that he needs to stop. I could then see PC GALLI spray her PAVA at these few males who have been very aggressive towards her. I have then seen loads of bottle being smashed around and one of which has hit me in the leg. Due to there being no radio signal I have told PC GALLI 3461AW to withdraw as we were outnumbered with several aggressive males and we needed to go out of the venue to gain radio signal to then go back in with additional resources. PC GALLI and I then went back into the lift to go down. When we entered the lift, the males who was involved and were fighting have then entered the lift with us and we went down to the minus 1 level. I have then left the males in minus 1 level as they were at a water fountain gasping to wash their eyes with water while PC GALLI and I went up to the ground floor by stairs and have managed to regain radio signal where I have then called for additional resources. Once more officers arrived in seconds we have then re entered the venue in which the males on minus one level were arrested. The topless male was no where to be seen after I lost sight of him in the minus one level. After everything has calmed down, I have exhibited blood from two locations on minus one level in which I believe is the topless male as he was bleeding.

I would describe the topless male to be IC1, around 5ft7, muscle build and around 25-30 years of age.

--- Victim Personal Statement ---

Signature: *PC D Ali 2826PM*

Signature Witnessed by:

RESTRICTED (when complete)

Continuation of Statement of: Constable Dameen Ali

I have been a police officer serving in the London with the Metropolitan Police now for approximately two years. I am immensely proud to serve to the communities in LONDON. I come to work to protect people and help others, I have not come to work to be assaulted. My family were already concerned and worried for my safety when joining the police force. Often there are a news article of officers being assaulted and i did not wish to be one of those. I do not ever risk to go home telling my family I have been assaulted and this will only increase my family's risk and safety for me work.

I have exhibited my body worn video for this incident as DAL/01- This shows the arrival on scene and the encounter.

I have exhibited the swabs taken from two locations which are on minus one. One of which was on the fire exit door and the other was on the staircase. Both swabs from both locations were taken one dry and one wet.

I exhibit the swabs from the fire exit door as DAL/02 with 105 number: 29 in seal bag: MPSB26697727  
I exhibit the swabs from the staircase as DAL/03 with 105 number: 30 in seal bag MPSB26697226.  
Both swabs exhibit were taken into 66 reference: 36214.

Witness Signature: PC D Ali 2326AW

Signature Witnessed by:

## WITNESS STATEMENT

Criminal Procedure Rules, r 27. 2; Criminal Justice Act 1967, s. 9; Magistrates' Courts Act 1980, s.5B

URN 

Statement of: Manuela GALLI

Age if under 18: Over 18

(if over 18 insert 'over 18')

Occupation: Police Officer

This statement (consisting of 3 page(s) each signed by me) is true to the best of my knowledge and belief and I make it knowing that, if it is tendered in evidence, I shall be liable to prosecution if I have wilfully stated in it anything which I know to be false, or do not believe to be true.

Witness Signature:  3461 AW Date: 10/07/2022

This is a statement relating to an incident that occurred whilst on duty whereby I was a victim of assault.

The relevant people mentioned throughout this statement are myself, my colleague who I was partnered with, PC ALI 2326AW, the person who assaulted me is unknown as I was assaulted from behind and at no point saw this person, I will refer to them as 'my attacker'.

On SUNDAY 10<sup>TH</sup> JULY 2022, I was on duty in full uniform, tasked with cycling patrols in the WEST END of LONDON. I was paired with my colleague PC ALI 2336AW, when a call came over my personal radio at approximately 2230 hours, regarding a large fight at the W HOTEL, WARDOUR STREET, W1. I assigned myself and PC ALI to the call, CAD 8070/10JUL22 refers. PC ALI and I arrived on scene at approximately As soon as we arrived, security from the hotel approached me and told me the incident was taking place on the first floor of the hotel, I relayed this information over my personal radio and requested further assistance. As PC ALI and I were in the lift, we could hear a lot of shouting from a large number of people and lots of glass smashing., I exited the lift and I saw approximately thirty (3) to forty (4) people shouting and glass bottles being thrown across the room. PC ALI and I immediately tried to separate parties from each other to stop the fighting, I was a constantly being pushed by people trying to get [passed me, who were continuously fighting with others the whole time. I saw an IC3 male trying to hit another male, throwing what looked like a full force punch, I drew my baton and struck him on his upper thigh, and the male stopped fighting and withdrew himself from the immediate area. I then decided that my baton was not the most effective use of force for this incident due to the number of people involved, so I holstered my baton and drew my PAVA. As I was doing this I felt something hit my back with force, at the same time, something hit my right forearm, just below my elbow. I did not see what

Witness Signature:  3461 AWSignature Witnessed by Signature:  2326AW

Page 1 of 3

## Continuation of Statement of:

hit me or who as I was facing the other way trying to contain a group of people fighting, however I felt the pain immediately, I checked to see if I was bleeding but was not. I then drew my PAVA and shouted "GET DOWN... I SAID GET DOWN" to try and detain and control those involved in the fight. At this point one of the males in the crown started walking towards me in an aggressive manner, trying to fight with those behind me, I pushed him back and deployed my PAVA on him and two or three more, who followed closely behind. As I do this I tell them to "STAY BACK", I tried to update MET CC on my personal radio that I had deployed my PAVA, however due to the lack of signal in the hotel, the message was not conveyed. I heard more shouting towards the back of the room, on the right-hand side of the lift, I turned around and I saw and IC1 male topless, who was struggling with another male that appeared to be a security officer from the hotel. I saw security trying to detain this male, however the topless male was swinging his arms around to get away and fight back. I grabbed hold of the topless male and tried to separate him from the security officer, I sprayed him with PAVA and he immediately let go of the Tying security officer. I then push him towards PC ALI, who was trying to get people in to the lift, to separate the fighting parties., PC ALI said words to the effect of "WE NEED TO GET DOWN, WE NEED MORE UNITS", we tried to get all the males who had be sprayed with PAVA, downstairs, to call for LAS and update control that PAVA had been deployed and request more units for help . As the doors to the lift were closing, I could see and hear glass smashing against the doors, and more people started to enter the lift and continue fighting. At one point, approximately eight (8) people were I the lift and taken to the ground floor in ruder to spate the parties and use our radios. We got to the ground floor, security staff directed us to a water fountain where those who had been sprayed with PAVA could wash their faces, PC ALI and I walked outside and called for for more units and told control that our PAVA had been deployed. I went back to the people who had been sprayed with PAVA, however a few had left in an unknown direction. A short while later, more officers arrived on scene to help control the fighting still going on upstairs. I told officers now on scene what I had witnessed and escorted them to the first floor of the hotel.

## Victim Personal Statement:

As a Police Officer, I am aware that I will be involved in violent disorder from time to time. It is my duty to protect LONDON and those visiting and living in the city. I am fully aware of the dangers I can put myself in in performing my duties, however I never expect to be personally attacked in such a way where I am left with

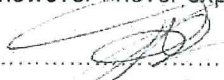
Witness Signature:  - 3461AW

Signature Witnessed by Signature:  29910AW



Continuation of Statement of:

visible physical injuries. I consider myself to be a person of reasonable firmness, however this particular incident has left me somewhat shaken. I feel well in myself, I have a physical mark on my arm with swelling and pain.

I have exhibited my body worn video for this incident as MAG/01 – This shows the arrival on scene and use of force used

I have exhibited my PAVA spray Serial 2106715 as MAG/02.

Witness Signature:  3461AW

Signature Witnessed by Signature:  2990AW

### WITNESS STATEMENT

Criminal Procedure Rules, r 27. 2; Criminal Justice Act 1967, s. 9; Magistrates' Courts Act 1980, s.5B

URN

Statement of: James Gray

Age if under 18: Over 18 (if over 18 insert 'over 18') Occupation: Police Constable

This statement (consisting of 1 page(s) each signed by me) is true to the best of my knowledge and belief and I make it knowing that, if it is tendered in evidence, I shall be liable to prosecution if I have wilfully stated in it anything which I know to be false, or do not believe to be true.

Witness Signature: *James 3022AW* Date: 25/07/2022

I am the above named officer and I have been a police constable in the METROPOLITAN POLICE for 2 years and 3 months. I am a member of WEST END PROACTIVE PARTNERSHIP TEAM 4 and conduct foot patrols in the WEST END footprint.

On 10<sup>th</sup> JULY 2022 at approximately 2230 hours I was on duty in full uniform when I attended an urgent assistance a W LONDON, 10 WARDOUR STREET, W1D 6QF. There was a report of an AFFRAY and 6 members of the SIA security staff were assaulted, two of which were hit over the head with glass bottles. I attended the W LONDON, triaged and delivered first aid to the 6 security and assisted with conveying them to hospital for treatment where I also took two of their statements. During my interaction with the security guards I overheard one of them saying they had raised concerns with the W HOTEL in regards to the clientele that they were inviting to the venue. The events were of 80 – 100 people and there was mention of previously violence and drugs use which made the securities job very difficult.

I do not recall which member of staff stated this out of the 6 as the situation was heated and a number were distressed due to bleeding head injuries.

I took statements off [redacted] date of birth [redacted] and [redacted]

I exhibit my body worn as JJG/01. This shows my interactions with the security at the venue and at ST THOMAS HOSPITAL A and E.

[Large handwritten signature area]

Witness Signature: *James 3022AW*

Signature Witnessed by Signature: .....

WITNESS STATEMENT

CJ Act 1967, s.9 MC Act 1980, ss 5A(3)(a) and 5B...

Statement of [redacted]

Age if under 18 [redacted]

Occupation SECURITY

This statement (consisting of 6 pages) each signed by me) is true to the best of my knowledge and belief and I make it knowing that, if it is tendered in evidence, I shall be liable to prosecution if I have willfully stated in it anything which I know to be false or do not believe to be true.

Date: 11/07/2022

Signature: [Signature]

Time: 02:28

I am the above named person an I have been employed as a security guard with SIA since January 2022. I work for SIA which is a agency that supplies security to WJ HOTEL WAREHOUS STREET WIP 60F. This statement describes when I witnessed a [redacted] and was hit in a head ~~of~~ the head with a glass. ON SUNDAY 10TH JULY I WAS WITNESSING A

Signature: [Signature]

Continued: 2000 hours to 0800 hours.  
 The incident took place at bar on the first floor of W Hotel. When I started work I knew that all of the party at the venue were on more than alcohol due to their behaviour. When I entered the males toilet on the 1st floor at approximately 2300 hours I saw three males inside the toilet one inside a cubicle door with white powder. One of the males had white powder on his nostril. I told all 3 they could not do drugs in the venue. I held them in the toilet until my supervisors [redacted] to remove the 3 males. We had to take them to the service exit. The 3 males swore calling me and my colleagues "PARCIS" and were swearing at us

Signature: 

Continued: We were able to walk them a far as the bar. The 3 males were back with the 100 odd party goers. Approximately 12 became aggressive to which I then ran to the duty officer and told them we need police. I then went back with 4 or 5 of my colleagues. As soon as I returned I told them all the party was over they need to go home. I locked our part of the males I had removed from the toilets and saw another male with a beard, black guy with two bottles properly 18 but someone with 2 bottles when I then received a punch I cannot remember to where. I then pushed his male into the black male with the beard to get him away from me and then they massively escalated and I

Signature: 

Continued: was pushed to the floor because the floor was slippery. I was repeatedly kicked and punched. My colleague [redacted] picked up and then I used a bottle smashed against the left hand side of my head. I walked to the side and the bar staff moved me to one side. It appeared that people were trying to run towards the elevators but fighting door staff. At this point it was still only security. The fight moved to the elevators. There was glasses, bottles being thrown everywhere. Everything was in the air. When the fight had moved I was sat down and given first aid. I was bleeding heavily from the side of my head. Police arrived 5 mins after I was hit.

ST

Signature: [Signature]

Continued: The 2 males I found <sup>37</sup>

in the bathroom. One was white, fat guy, shorts, black hair shirt 2nd male white, tattoos, Essex people. The 3rd male was also white. The black male who was swinging the bottles short, bald, beard around his jaw, T shirt. ~~There~~ I cannot recall any further suspects due to amount of - ST people present. My Colleagues who were present were [redacted] who left straight away and was not involved after the disorder broke out [redacted] was also present all of which I work with at SIA who I have known since January when I joined. I would be willing to attend court [redacted] present [redacted]

ST

Signature: [Signature]

Continued: Victim personnel statement <sup>38</sup>  
This has been very upsetting  
due to the way we act I  
was concerned for my - 09  
colleagues, ~~me~~ <sup>my</sup> guests. I  
am not sure if I would  
feel safe going back to work.  
I have received a gash to  
my head that has required  
gluing.

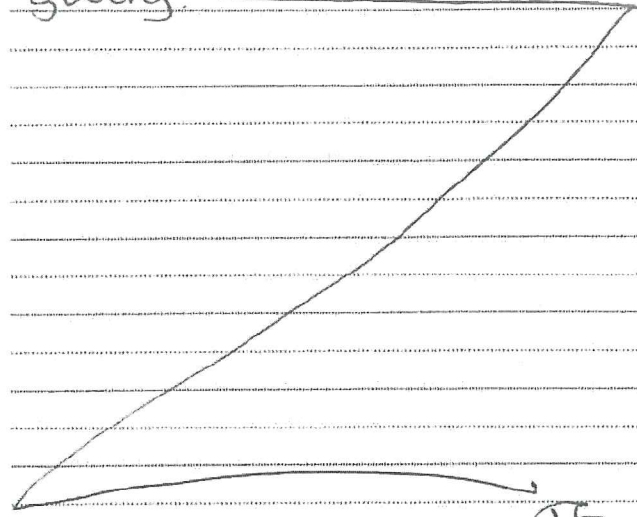

Signature: ~~Any~~

Continued:

Signature:

### WITNESS STATEMENT

Criminal Procedure Rules, r 27. 2; Criminal Justice Act 1967, s. 9; Magistrates' Courts Act 1980, s.5B

URN

Statement of: PC ABBIE DOBSON

Age if under 18: OVER 18 (if over 18 insert 'over 18') Occupation: POLICE CONSTABLE

This statement (consisting of \_\_\_\_\_ page(s) each signed by me) is true to the best of my knowledge and belief and I make it knowing that, if it is tendered in evidence, I shall be liable to prosecution if I have wilfully stated in it anything which I know to be false, or do not believe to be true.

Witness Signature: Abbie Dobson 2596AW Date: 11/07/2022

This statement relates to the time I arrested a male I now know to be [REDACTED] (20/07/1989) for Grievous Bodily Harm. I have not met this male before today's incident.

On SUNDAY 10<sup>th</sup> JULY 2022 I was on duty in full police uniform on mobile patrols, call sign AW31N with PC TAIT 1941AW and Special Constable ABRHART 5747AW. A call was circulated via my personal radio stating that there was a fight in progress at 10 WARDOUR STREET, W1D 6QF, this was circulated as an immediate response call. A colleague has then called up on the radio stating they needed more units at the location, to which I have assigned AW31N to.

After some time at the location, BRONZE WESTEND has pulled myself and a few of my colleagues to one side and asked PC TAIT to relay what he had seen on CCTV of the incident. PC TAIT informed me that he had seen a male wearing a WHITE 'PALM ANGELS' t-shirt, throwing bottles into the crowd which had subsequently hit someone in the head causing the male to fall to the ground and have a laceration to his RIGHT eyebrow. I have then approached [REDACTED] with PC TAIT, PC TAIT has walked in front of me and taken [REDACTED] by the LEFT arm to place him in handcuffs. As PC TAIT has done so, I have said words to the effect of "YOU ARE UNDER ARREST FOR GBH. YOU DO NOT HAVE TO SAY ANYTHING BY IT MAY HARM YOUR DEFENCE IF YOU DO NOT MENTION WHEN QUESTIONED SOMETHING YOU LATER RELY ON IN COURT. ANYTHING YOU DO SAY MAY BE GIVEN IN EVIDENCE. NECESSITY FOR YOUR ARREST IS TO PREVENT HARM AND PROMPT AND EFFECTIVE INVESTIGATION BY MEANS OF A TAPE RECORDED INTERVIEW. TIE IS 2311 HOURS."

Myself and another colleague have then walked [REDACTED] to the lift, taken him downstairs and to a police marked minibus, which we have used to transport [REDACTED] to HAMMERSMITH POLICE STATION. We arrived at HAMMERSMITH POLICE STATION at 2346 hours. Detention was authorised by PS WALSH at 0138 hours on MONDAY 11<sup>th</sup> JULY 2022.

My body worn video was recording at the time of the arrest which I have not viewed prior to writing this statement. I exhibit this as AED/01.

As well as my body worn video I have seized [REDACTED] PALM ANGELS t-shirt. This is due to there being blood splatter on his tshirt that couldn't be accounted for. I exhibit this as

Witness Signature: Abbie Dobson 2596AW

Signature Witnessed by Signature: .....

Continuation of Statement of:  
AED/02. This was placed in a paper bag, sealed by myself and booked into HAMMERSMITH  
105 book under reference 105/11395.

This concludes my statement.



~~Signature~~  
2596AW

Witness Signature: ~~Signature~~ 2596AW

Signature Witnessed by Signature: .....



WITNESS STATEMENT

Criminal Procedure Rules, r 27. 2; Criminal Justice Act 1967, s. 9; Magistrates' Courts Act 1980, s.5B

URN

[Empty boxes for URN]

Statement of: PC HOLDEN

Age if under 18: Over 18 (if over 18 insert 'over 18') Occupation: POLICE CONSTABLE

This statement (consisting of 2 page(s) each signed by me) is true to the best of my knowledge and belief and I make it knowing that, if it is tendered in evidence, I shall be liable to prosecution if I have wilfully stated in it anything which I know to be false, or do not believe to be true.

Witness Signature: ...PC HOLDEN 1125AW.....Date: 11/07/2022

I am the above named person and this is an exhibiting statement in regards to the offences of GHB, ABH and Affray at W LONDON on the 10<sup>th</sup> JULY 2022.

On SUNDAY 10<sup>TH</sup> JULY 2022 officers were called to a fight on the first (1<sup>st</sup>) floor of W LONDON, LEICESTER SQUARE. PC GALLI sustained injuries to her right arm due to the bottles that were being thrown and from various punches in the affray.

I exhibit HJH/01 as PC ALIs POLICE HIGH VIS JACKET – 66/36215 – 105/9227. Blood from a suspect is found on the right upper arm sleeve.

I exhibit HJH/02 HJH/03 and HJH/04 as photos of the injuries sustained to PC GALLI's right arm.

PC HOLDEN 1125AW

Signature:PC HOLDEN 1125AW.....

Signature Witnessed by Signature:.....

### WITNESS STATEMENT

Criminal Procedure Rules, r 27. 2; Criminal Justice Act 1967, s. 9; Magistrates' Courts Act 1980, s.5B

URN 01 FH 03474 22

Statement of: PC Antonia RAYFIELD 2989AW

Age if under 18: Over 18 (if over 18 insert 'over 18') Occupation: Police Constable

This statement (consisting of 1 page(s) each signed by me) is true to the best of my knowledge and belief and I make it knowing that, if it is tendered in evidence, I shall be liable to prosecution if I have wilfully stated in it anything which I know to be false, or do not believe to be true.

Witness Signature: *[Signature]* 2989AW Date: 06/06/2022

This statement refers to the arrest of a male who I now know to be [redacted] date of birth [redacted] for Affray and Common Assault inside W HOTEL on WARDOUR STREET, W1.

On SUNDAY 10<sup>TH</sup> JULY 2022 at approximately 2232 hours the Emergency button went off on the radio, by PC ALI 2326AW, to attend W HOTEL, on WARDOUR STREET for a fight that was breaking out between hotel guests and staff inside the hotel. Immediately, I, PC MATTHEWS 3473AW, PC OSULLIVAN 2866AW, and PS CORCORAN 213AW drove to the address as urgent assistance was required. On arrival to the scene, the BROZE WEST END INSPECTOR, PARKER PHIPPS informed myself and my colleague PC MATTHEWS that a fight had broken out inside the hotel and two males were being detained by officers on the ground floor in a back room of the hotel. We followed INSPECTOR PARKER PHIPPS to find the detained males, and when we were led to a storage room, the INSPECTOR informed us that the two (2) males needed to be arrested for the alleged offence of Affray. I approached [redacted] and told him that because he had been fighting with multiple men on the first floor of the hotel that he was under arrest for Affray, as I was satisfied the threshold had been met for the offence. I arrested [redacted] at 2306hrs on suspicion of Array. I fully cautioned [redacted] and said "YOU DO NOT HAVE TO SAY ANYTHING BUT IT MAY HARM YOUR DEFENCE IF YOU DO NOT MENTION WHEN QUESTIONED SOMETHING WHICH YOU LATER RELY ON IN COURT. ANYTHING YOU DO SAY MAY BE GIVEN IN EVIDENCE". [redacted] did not reply to caution. I informed [redacted] that the necessity of the arrest was to prevent further harm and for prompt and effective investigation by way of interview. [redacted] was placed in a rear stack handcuff position. I asked if the handcuffs felt comfortable and then double locked them. Arrangements were then made for cell space and transport were carried out.

I and PC OSULLIVAN 2866AW escorted [redacted] to the police van and we were driven to HAMMERSMITH POLICE STATION. Whilst on route to custody, we received a call that [redacted] could be seen on CCTV throwing punches at staff at the W HOTEL. Once we arrived at custody at 2340 hours, [redacted] was further arrested for Common Assault at 2342 hours. I fully cautioned [redacted] again and said "YOU DO NOT HAVE TO SAY ANYTHING BUT IT MAY HARM YOUR DEFENCE IF YOU DO NOT MENTION WHEN QUESTIONED SOMETHING WHICH YOU LATER RELY ON IN COURT. ANYTHING YOU DO SAY MAY BE GIVEN IN EVIDENCE". [redacted] did not reply to caution. I informed [redacted] that the necessity of the arrest was to prevent further harm and for prompt and effective investigation by way of interview.

Witness Signature: *[Signature]* 2989AW

Signature Witnessed by Signature: .....



Continuation of Statement of:

I presented the above to the Custody Sergeant and detention was authorised at 0029 hours.

I exhibit my body worn of the arrest as AGR/01.

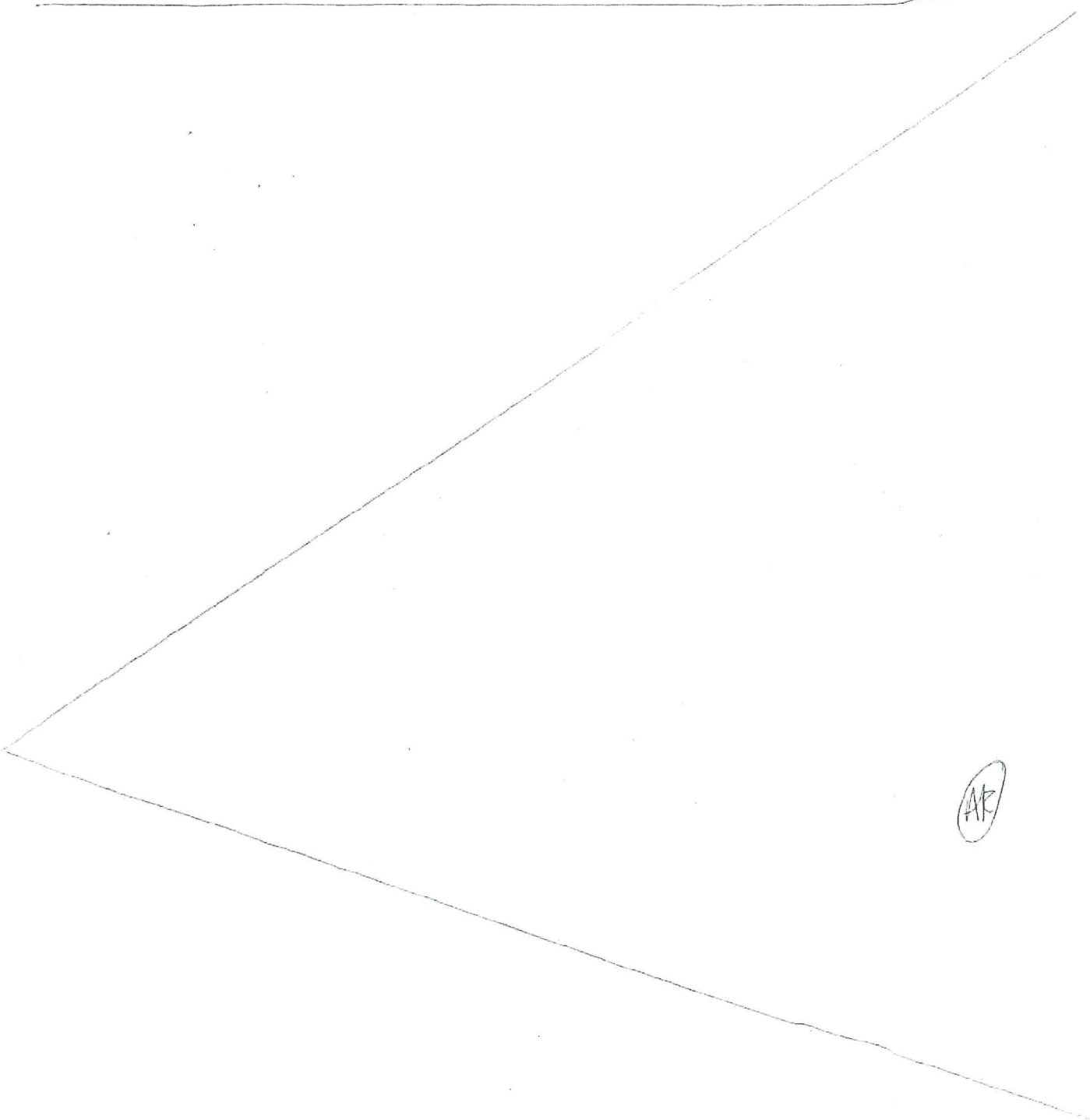

AK

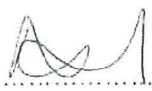
Witness Signature:  2989AW

Signature Witnessed by Signature: .....

